

IMPORTANT SAFETY AND INSTALLATION INSTRUCTIONS

WARNING: Risk of fire and electrical shock. This product is to be installed by a qualified electrician only.

CAUTION: When using electrical equipment, basic safety precautions should always be followed including the following: Read all instructions carefully before installation and save

for future use. Make sure installation and all connections are in accordance with National Electrical Code and any local regulations. To avoid possible electrical shock, be sure that power supply is turned off before installing or servicing this fixture. Servicing should be performed by qualified service personnel.

These instructions do not claim to cover all details or variations. When additional information is desired, please contact your SPI representative.

Wet Location Switch Box Mounting

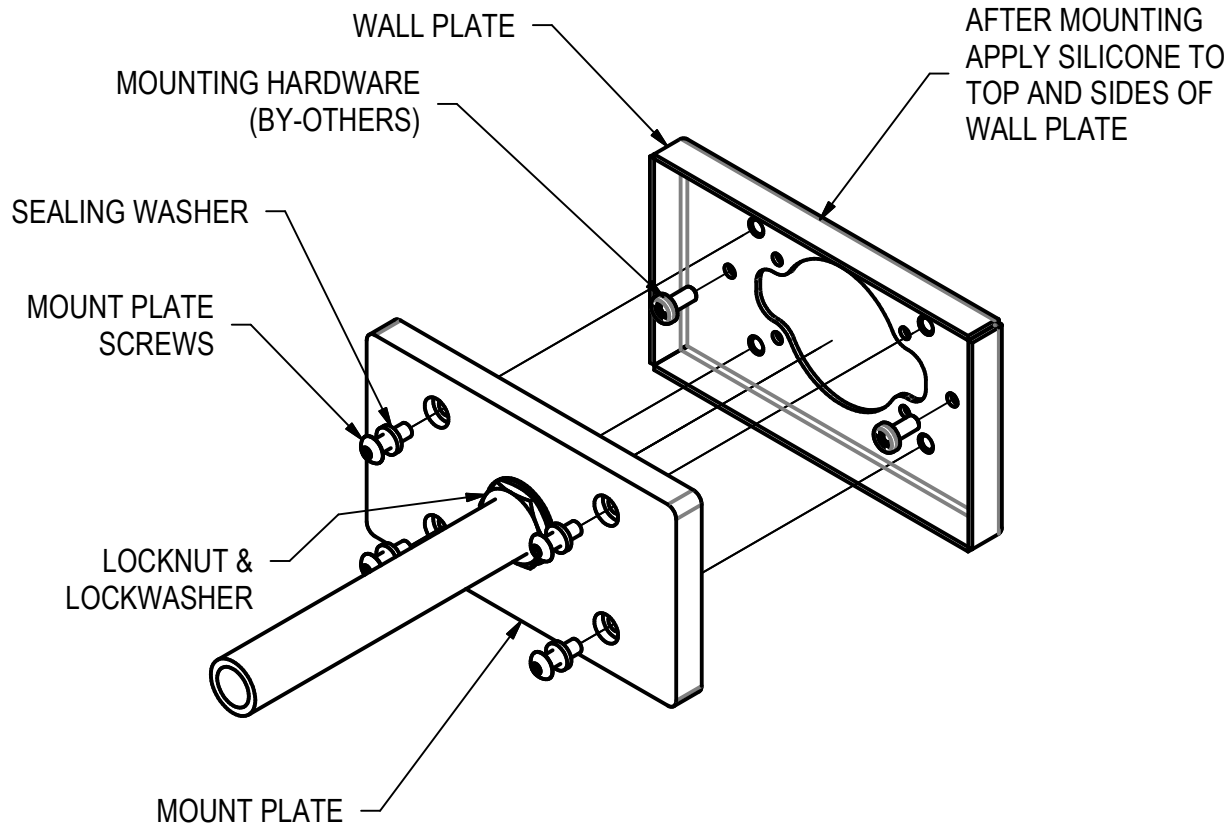

1. MOUNT WALL PLATE TO WALL OR SWITCH BOX WITH HARDWARE (BY-OTHERS)
2. ATTACH STEM PLATE TO STEM. KEEP LOCK WASHER LOOSE AT THIS TIME.
3. MAKE WIRE CONNECTIONS PER LOCAL CODE.
4. ATTACH MOUNT PLATE TO WALL PATE USING SCREWS AND SEALING WASHERS PROVIDED.
5. TIGHTEN THE LOCKNUT AND LOCKWASHER ON THE STEM TO KEEP STEM SECURE.
6. APPLY SILICONE ON THE EDGE OF PLATE/MOUNTING SURFACE ON THE TOP AND SIDE OF WALL PATE.

Styk

04/13/11
IS71648X